

Device Specifications

General	
Chipset	ARM Cortex-M33
Memory	32 MB (Over 300 hrs of offline use)
Weight(band and strap)	82g
Dimensions	2.7 x 2.8 x 0.53 in. / 68.6 x 71.1 x 13.5 mm
Ruggedization	IP68, High impact polycarbonate plastic
Strap	Durable Polyester, Nylon hook and loop, Elastic rubber
Ports	Proprietary dual magnetic charging port
Operating Temperature, Humidity	-20C to +55C, 5% to 95% relative humidity (non-condensing)
Storage/ Charging Temp.	0C to +45C
Location of Usage	Indoor and outdoor use permitted
Altitude	Max = 5 km, Min = 0 km
Wet Location	Wet Location Use Permitted
Max Pollution Degree	4

Device Specifications

Sensors	
6-Axis IMU	Gyroscope, Accelerometer
Body Proximity Sensor	Advanced On Body detection
PPG Sensor	Industry-leading sensor that measures wide variety of biometric data
Feedback	
Vibration	High G-force haptic motor
LED	Quad RGB LED indicators
Battery	
Capacity	700 mAh, 3 Wh, Lithium-ion polymer, UL1642 Certified
Connectivity	
Bluetooth	Bluetooth® 5.3
Cellular Data	LTE-M / NB-IoT (subject to regional support)
GPS	L1 Band

Accessories + What is Included in the Box

Included Accessories	
Inside BAND V2 Box	BAND V2, CHARGER V2 Cable, CHARGER V2 AC/DC Adapter, BAND V2 Information Booklet, STRAP V2
Accessories	
MULTI-CHARGER V2	High capacity charging system
GATEWAY V2	Network adapter for cell-denied or restricted areas
BEACON V2	Ambient environment monitoring, Collision Avoidance, Indoor location / zone tracking
CHARGER V2 Specifications	
Cable	4 ft, Ultra-Flexible Cable
AC/DC Adapter	Input: 100VAC - 240VAC 50/60Hz Output: 6.2VDC, 1A UL Listed : E502188

Legal Information

This device complies with part 15 of the FCC Rules. Operation is subject to the following two conditions: (1) this device may not cause harmful interference, and (2) this device must accept any interference received, including interference that may cause undesired operation. FCC ID: 2A357002 , Contains FCC ID: 2A3579160

IC Warning: This device complies with Industry Canada licence-exempt RSS standard (s). Operation is subject to the following two conditions: (1) this device may not cause interference, and (2) this device must accept any interference, including interference that may cause undesired operation of the device.

Any change or modification not expressly approved by SlateSafety could void the user's authority to operate equipment.

This device is not a medical device and is not designed or intended for use in the diagnosis of disease or other conditions, or in the cure, mitigation, treatment, or prevention of disease.

For Device Warranty Information, please visit: slatesafety.com/warranty

For Terms of Service, please visit: slatesafety.com/terms-of-service

For Privacy Notice, please visit: slatesafety.com/privacy-notice

FireHUD Inc. d.b.a SlateSafety BAND V2



BAND V2 User Manual

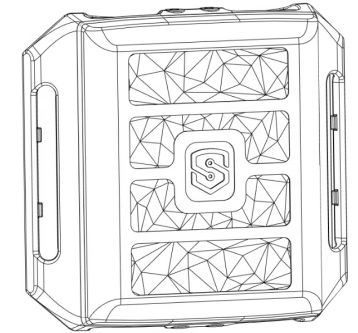

Proper Device Usage

The BAND V2 should be worn on the upper arm with **direct skin contact to the sensor**.

For optimal performance, wear the device high on the upper arm and away from tattoos.

The strap should be tight enough so that the device doesn't move around easily on the arm, but loose enough as to not cut off blood circulation.



Charging

There are two charging options for the BAND V2:

1. Attach CHARGER V2 (included + pictured)
2. Insert device into MULTICHARGER V2 (not included)

While charging, the device will display pulsing blue LEDs. After charge completion while still on the charger, the device will display solid magenta LEDs.

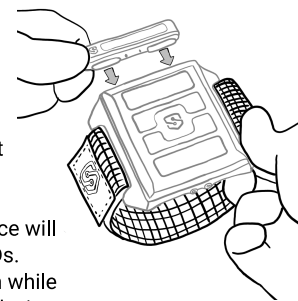

Setup Information

Important - Before device usage, ensure that the BAND V2 has been properly assigned to a User with a Loadout in the SlateSafety software, located at app.slatesafety.com.

Alerts - If Alert thresholds are set in the User's Loadout, an Alert will trigger when any Alert threshold is crossed. When an Alert is triggered the BAND V2 will notify the User with vibrations and LED feedback.

Return to Work - If Return-To-Work thresholds are set in the User's Loadout and they have recently triggered an Alert, a Return-To-Work will trigger when all Return-To-Work thresholds are crossed. When a Return-To-Work is triggered, the BAND V2 will notify the User with two short vibrations and green LED feedback.

Usage Information

Cleaning - Certain chemicals can damage the plastic housing of the device. The device should be cleaned only with simple soap and water and disinfected only with isopropyl alcohol wipes. Super Sani-Cloth® wipes are the recommended disinfecting wipe. The elastic straps can be removed and laundered separately.

On Body Mode - The BAND V2 uses a combination of sensors to determine when the device is being worn. Once worn, the device will provide brief feedback to the User via one short vibration and one orange LED pulse.

Sleep Mode - When not being worn and not being charged the BAND V2 will go into a low power sleep mode in order to conserve battery. It will awaken automatically once placed on charger or on the arm.

Support Information

For additional support materials, or to open a support ticket please visit: slatesafety.com/support

For email support, please email: support@slatesafety.com

If you have any questions, comments, or concerns, please do not hesitate to reach out to a SlateSafety representative.

